

**In Case of Emergency**

**Dial 911**

**Our address is**

**9561 County Road 8 NW,**

**Garfield MN**

**Douglas County**

**Office 320-834-2345**



Download the app to get more out of your stay.

Open the app, hit the search button at the bottom of the screen, type In Oak Park

Campground, when you see our park name, tap the symbol next to our name and that will bring you into our campground information. Hit the three line symbol in the middle bottom. That will give you lots of great information such as notifications about things in the campground, activity reminders just before they start or what rental equipment we have available. You can then log out of our park and use the app to find another great camping spot.



**Our Camp store offers**

- Tombstone Pizza, cooked and delivered to your site.
- Frozen fully cooked breakfast sandwiches microwave ready in 3 minutes.
- Gifts, toys & souvenirs
- Post Cards and Stamps
- Sporting goods, camping & RV supplies
- Laundry soap, dish soap & other cleaning supplies
- Personal care items
- Pop, water, snacks, & candy
- Tea, coffee & hot chocolate
- Ice & Firewood

Camp Store Hours are Posted on the Door.

**Severe Weather Information**

When severe weather is impending please follow personal safety protocol. If a tornado watch or warning has been issued for Douglas County, MN sirens may sound and you should receive warnings on your phone, please seek shelter. Come to our office and proceed to the basement or our restrooms although coded are available 24/7. Please avoid windows and doors during a storm. Pets will be allowed in building to take shelter during storms.

If during a thunderstorm of any type, you do not feel safe in your tent or camper. Please don't hesitate to come to the office for shelter, if after hours please call the office and we will open the building for you.

**On site Rental**

Do you have family or friends that do not have a camper but would like to spend time camping with you? This might be a good option for them. This camper is all set up on site, just have them bring their linens, towels and personal items and they are ready to camp. Travel trailer sleeps 2

(2 night min.).....\$110/night

We do hope your stay is a pleasant one. Please stop by the office If you need assistance or information. Thanks for staying with us. Management



## Rules for Everyone's safety and Enjoyment

Please understand that we do our best to provide a family friendly campground .

- **REGISTRATION** is for 2 adults & 2 children, in ONE camping unit with ONE vehicle.
- **CHECK IN TIME:** Anytime after 1 pm and before 9 pm.
- **CHECK OUT TIME: 12:00 pm** Early arrival or late check out may be arranged with the office for a fee if site is available.
- **SPEED LIMIT: 5 MPH** strictly enforced.
- **VISITORS:** Our guests may have visitors between 8am and 9:30pm A fee is charged per person. Visitors must park in front parking area and register with the office. **Limit of 6 guests per site.** Unregistered guests will be ejected from the park.
- **VEHICLES:** Parking passes must be displayed at all times. Please park camper and 1 vehicle on the gravel pad. 2nd vehicle should park in overflow. Any vehicle over 2 pre site, will be charged a daily fee of \$3 and must park in front overflow parking.
- **All campers must go on the pad, in the direction shown on the map.**
- **QUIET HOURS:** Are observed from 10 pm to 7 am and are strictly enforced. All outdoor lights, radios & TVs must be turned off during quiet hours and voices should be at a whisper. Please be respectful at all times.
- **PLAYGROUND** is closed Dusk until 7 am. Parents are responsible for the safety and behavior of their children. Children under 18 must return to their campsite by 9:30 pm.
- **ALCOHOLIC BEVERAGES:** permitted at campsite only. Non-prescription drugs are not allowed on the property.
- **CANNABIS:** the use of is not permitted on the property without prescription.
- **PERSONAL CONDUCT:** Any type of public disturbance will not be tolerated. Disorderly ill mannered conduct and drunkenness will not be tolerated. A public domestic disturbance will immediately terminate camping agreements and the site must be vacated immediately. If the police must be called for any disturbance the campsite must be vacated immediately - NO REFUND. All guests must comply with all federal, state, and local laws and campground rules.
- **PROFANITY:** Please refrain from using profanity while in the park.
- The use of **FIREARMS, BOWS and ARROWS, SLINGSHOTS, SPARKLERS or FIREWORKS** of any type are **not allowed.** Firearms must be unloaded and completely contained in a fully enclosed gun case or unloaded and contained in the closed trunk of a vehicle.
- **ATV'S, GOLF CARTS, CHILDRENS MOTORIZED VEHICLES** are not allowed, unless approved by management.
- **Please do not walk through other guests sites or neighboring properties.**
- **POND:** No wading or swimming in pond.
- **WASHING/MAINTENANCE:** of Vehicles or Trailers is not permitted.
- **No CLOTHESLINES/HAMMOKS/DOG TIES** attached to trees.
- **KIDDIE POOLS/HOT TUBS/SCREEN ROOMS WITH FLOORS:** are not allowed.
- **MATS/RUGS:** are not allowed on the grass. Please ask before putting one down.
- **FIREWOOD:** No outside Firewood allowed unless MN certified.



**POOL HAS NO LIFEGUARD ON DUTY SWIM AT OWN RISK.** Food and drink are allowed on the pool deck but not in the pool. NO GLASS CONTAINERS. **No one can be in the pool alone.** Children who are accomplished swimmers **OVER the age of 14** may enter the pool, all other children must be accompanied and supervised by an adult (someone 18 or over) at all times at the pool. Additional pool rules posted at the pool must be read and observed.



**Dumpster:** located by the dump station, and is for regular trash generated from using your kitchen or bathroom while



### Boats & Fish Cleaning

We have a table set up by the dumpster for fish cleaning. **Do not throw fish in dumpster.** Boats must park in overflow parking. If you need to charge boats or equipment please make arrangements with the office.



**Pets** are allowed, however if they show any signs of aggression they will need to leave the campground. They must be on a **hand held 6' or less leash** and under control at all times. They poop, you scoop. Please be sure to read and abide by our **People Owner Courtesies** and get a treat for them at the office.

# Our Amenities



**Restrooms and showers** are located at the east end of the main building and are closed daily for cleaning. Porta Potty is available by pool. Young Children should always be supervised in the restrooms.



**Laundry:** We have 2 washers (\$2.00/load) & 2 dryers (\$2.50/load). We sell laundry soap, dryer sheets and quarters in the store.



**Playground** is open from 7am until Dusk.



**Pool** is open from 10 am until Dusk.

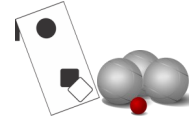

**Yard Games:** we have bean bag toss, bocci ball, yard Yahtzee, connect four and checkers available for families to use by the playground. Check out the necessary equipment from the camp store.



Paddle boats can be signed out by an adult (18 or older) in the office between 9am & 7pm. All riders must wear life jackets and children must be at least 12 yrs. old to be on the boat without an adult. Time limit of 1/2 hr.



## Recreation and Theme Weekends



Each weekend we offer activities for all ages, such as scavenger hunts, KAMPO, tie dye, ceramic painting, group games, wagon ride and crafts. We do activities 3 times a day on Saturday. We try to offer free activities along with the ones that have a fee. If the activity has a fee it will have (\$) next to it on the activity board. We also have some self guided scavenger hunts available in the camp store, pick up the clues complete the hunt and then turn the paper in for a prize. Children under 6 must be accompanied by an adult while participating in the rec activities.

## 2026 Reservations

Reservations for the 2025 season can be made January 1, 2026.

## August Construction Special

For \$550.00, rent a site from August 2nd through August 25th and camp 2 weekend nights and one weekday night for all 4 weekends. (Pay regular weekday rate, for any extra weekday nights you camp.) Camper stays onsite plugged in.

## Things to do In the Alexandria Area

If you are new to our area and are looking for some fun suggestions of things to do, we have brochures in the office and laundry room. Some of our favorites are the local wineries, distillery and breweries. Casey's amusement center, a picture with Big Ole is a must. The Boat and Runestone Museums. The area offers some great hiking and biking with the rail trail and Kensington and Brophy parks. Walk to the top of Inspiration Peak and enjoy a great view of our county. The farmers market is Tuesday morning, Thursday afternoons and Saturday mornings. Thursday evenings enjoy music on the courthouse lawn. Whatever it is you are looking for we can help you find it. There are several great restaurants in the area for breakfast, lunch or dinner.



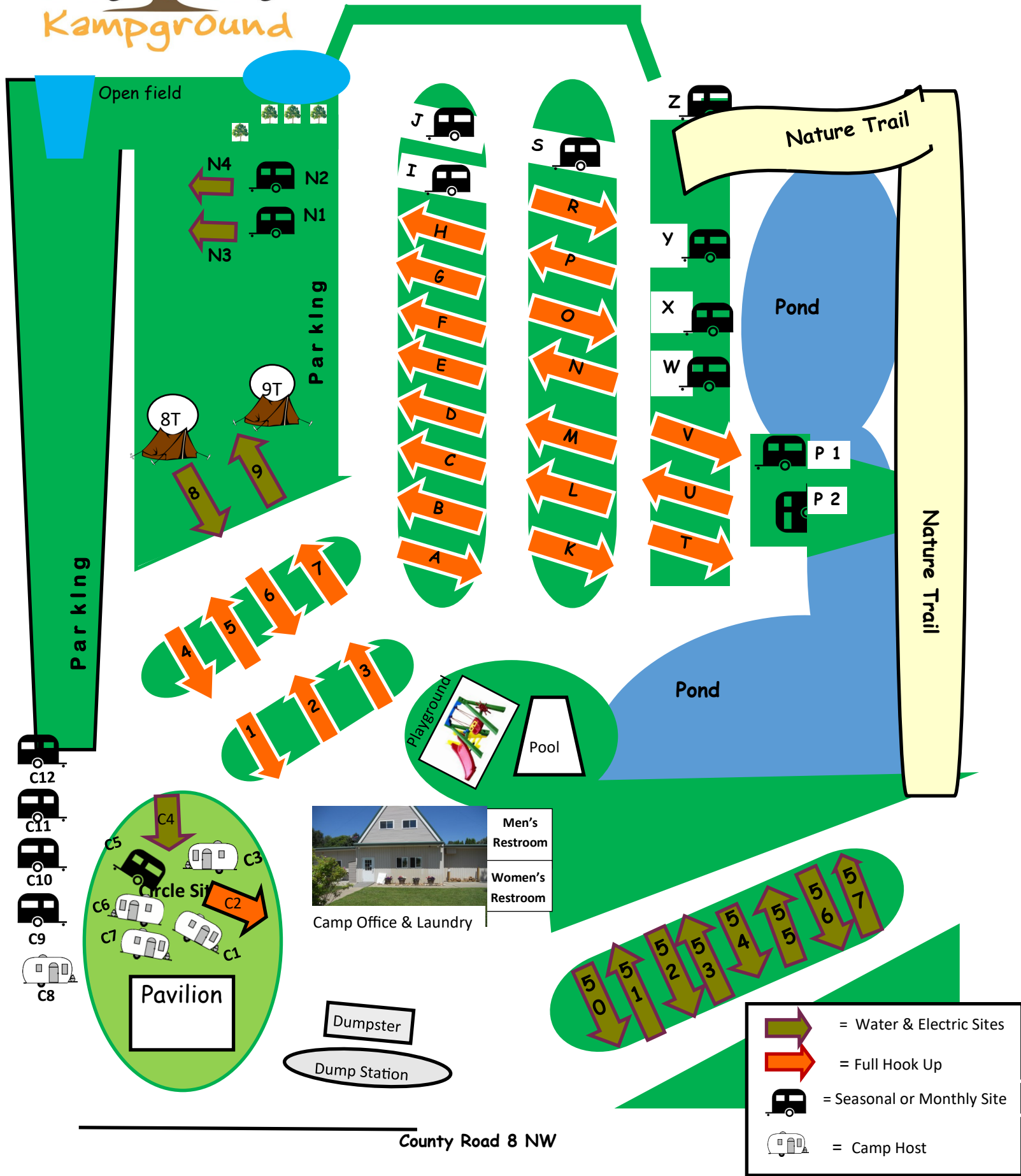

### Beaches Nearby

Lake Brophy offers a sandy beach, fishing pier, bike trails, and an awesome playground.. Lake Latoka, offers a sandy beach and boat launch. Both are just 6 miles from the campground. (before construction)

# Oak Park Kampground



County Road 8 NW

-  = Water & Electric Sites
-  = Full Hook Up
-  = Seasonal or Monthly Site
-  = Camp Host